



[www.santos.fr](http://www.santos.fr)

**ESPRESSO COFFEE  
GRINDER # 06**



Internationally patented models





## THE GENUINE ESPRESSO COFFEE GRINDER

### Traditional reliable and robust coffee grinder.

Easy to use and efficient, the coffee grinder # 06 will give you a high quality grinding. Ideal for hotels, bars, restaurants, catering...



**Average output  
8 kg/hour**

**Precision grinding,**  
from very fine to coarse.  
Easy to adjust

**Powerful reliable commercial motor**  
**5-year warranty**

Stainless steel and aluminium body

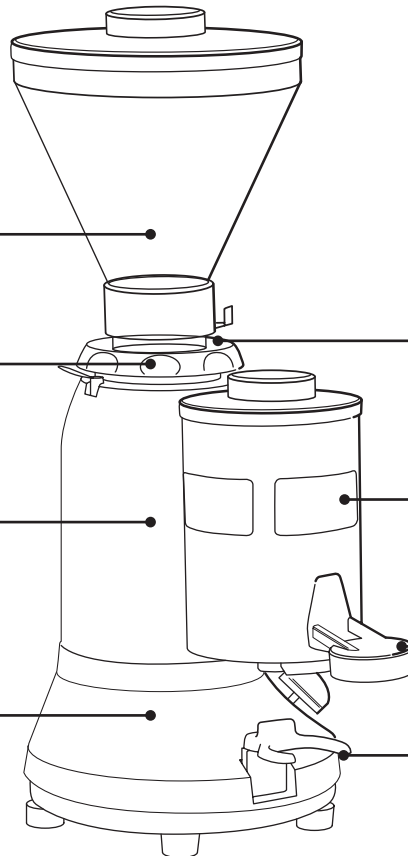

1 kg (2.2 lbs) hopper



**# 06A Automatic espresso coffee grinder:** Starts and stops automatically to keep the portion dispenser full.

**Ø 63.5 mm (2,5") grinding discs:**  
high resistance, long lasting  
**Designed and manufactured  
by Santos for a high quality grinding**

**Very precise volumetric dispenser  
with counter.**  
Easy to adjust dosing (from 6.5 to 9 grams)

**Universal tamper**  
Ø 55 mm for all filters (single, double)

Filter holder fork, **for all types  
of filter holders**

## A FULL RANGE OF ESPRESSO COFFEE GRINDERS



**06**

**Historic**  
Reliable and robust



**40A**

**Classic**  
Silent, reliable and robust



**55**

**Automatic**  
Silent and quick.  
Warranty of fresh ground coffee



**60**

**Pratic**  
Silence, performance  
and modularity

# MOULIN À CAFÉ BAR N° 06



## COFFEE GRINDERS: SANTOS KNOW-HOW

www.santos.fr

### Santos, 57 years experience

- Since 1954, we manufacture our own grinding discs for better results
- Santos is the leader in “Silent” coffee grinders for 14 years
- Constant and fine grinding, constant portion dispensed
- No “burn coffee” effect while grinding, no electrostatic coffee phenomenon
- Easy to adjust (grinding and dosing) and to maintain (changing the grinding discs is very easy)



### TECHNICAL SPECIFICATIONS



#### Motor

Single phase: 110-120V – 50/60Hz – 310W – CE, UL  
220-240V – 50/60Hz – 360W – CE

Speed: 1 500rpm (50Hz)  
1 800rpm (60Hz)



#### Weight

Net: 10Kg (22lbs)  
Shipping: 12Kg (26lbs)

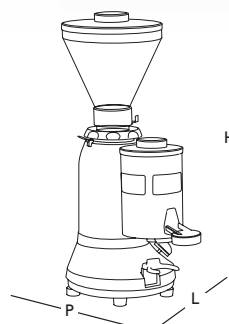

**APPLIANCE**  
P: 280 mm (11")  
L: 230 mm (9")  
H: 570 mm (22.4")



**EMBALLAGE**  
P: 350 mm (13.8")  
L: 290 mm (11.4")  
H: 540 mm (21.2")

### SAFETY, STANDARDS, HYGIENE

#### In accordance with the following regulations

Machinery directive 2006/42/EC  
Electromagnetic compatibility 2004/108/EC  
“Low voltage” Directive 2006/95/EC  
Regulation 1935/2004/EC (contact with food)  
RoHS directive 2002/95/EC

Harmonized European Standards  
NF EN ISO 12100 - 1 and 2: 2004  
NF EN 60204-1: 2006

CE European standards, UL (USA) and cUL (Canada)

#### Electrical safety

- On/Off interlock switch is waterproof
- All mechanical parts are ground (earth) connected
- All equipment is perfectly controlled after assembly (special electrical testing bay)

#### Thermal Safety

Motor protected by internal thermal detector

#### Acoustic Safety

Very silent asynchronous motor

#### Hygiene

All removable parts can be put in a dishwasher or easily cleaned with hot soapy water.

**PRODUCT: 2-YEAR WARRANTY – MOTOR: 5-YEAR WARRANTY**



# ESPRESSO COFFEE GRINDER # 06

www.santos.fr

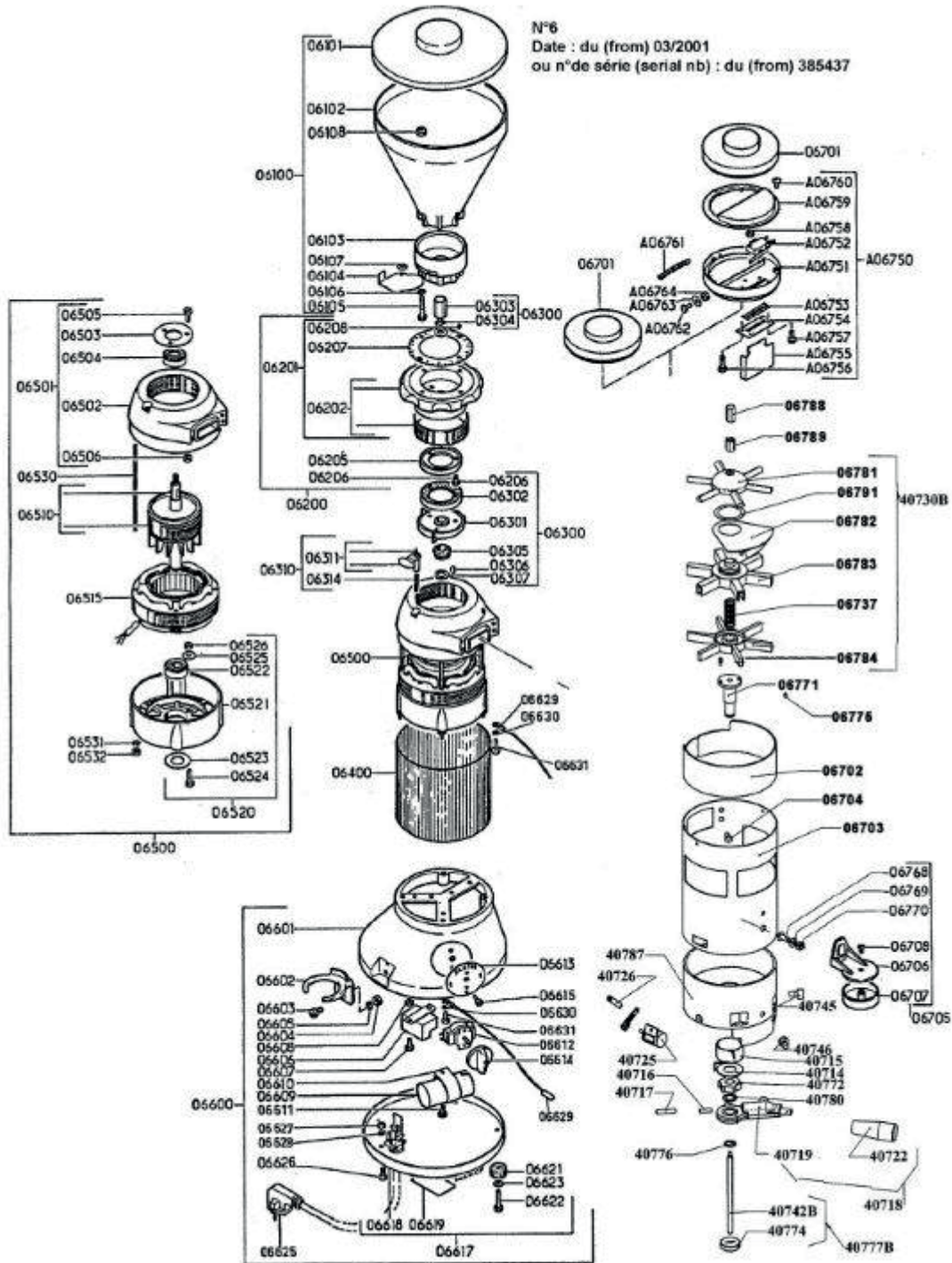

140-150 AV ROGER SALENGRO – 69120 – VAULX EN VELIN – LYON – FRANCE – TEL. +33 472 37 35 29 – FAX. +33 478 26 58 21  
Website: www.santos.fr – E-mail: santos@santos.fr